

**NOTICE OF TIMBER SALE  
NATIONAL FORESTS IN ALABAMA  
TUSKEGEE DISTRICT  
TIMBER SALE #20-10**

**GENERAL INFORMATION**

Acting as agent for the USFS, the Alabama Forestry Commission (AFC) offers for sale approximately 3,243 tons of pine sawtimber (includes pine chip-n-saw), 1,511 tons of pine pulpwood, 840 tons of mixed hardwood sawtimber, and 679 tons of hardwood pulpwood on approximately 208+/- acres. No representation is being made concerning the actual amount of timber which could be harvested from this tract. Bidders are expected to satisfy themselves as to both quantity and value of the timber before submitting a bid. By nature of this announcement, you are invited to bid on the timber described herein.

**LOCATION**

The sale area is located in the Tuskegee National Forest east of Tuskegee on Hwy 186 in portions of Sections 1, 2, 11, & 12, Township 17 North, Range 24 East, Macon County, AL, as shown on attached map.

**DESCRIPTION OF TIMBER**

This sale contains 47 acres (2 stands - 18 ac and 29 ac) of pulpwood-size Longleaf pines to be thinned, 35 acres (2 stands – 12 ac and 23 ac) of predominantly Loblolly pines to be clearcut, except for some Longleaf pine reserves, and 126 acres (3 stands - 23 ac, 50 ac, and 53 ac) of mixed pines to be select cut (see attached map). **Leave trees have been marked in orange paint on the pulpwood thinning portions. Only unmarked trees may be cut in this portion. Orange-painted trees are not to be cut. Only trees marked with yellow or blue paint may be cut in the 35 acre and 126 acre portions.** Sale boundaries are marked with 3 stripes of orange paint. No trees are to be cut outside of these marked boundaries. Penalties will be assessed for cutting of orange-marked trees, unmarked trees in the clearcut and select cut areas, or trees outside of the sale areas. All roads are to be maintained and restored to original or better condition upon completion of logging. Upon completion of logging, water bars are to be installed where needed on roads and skid trails to minimize soil displacement. BMP's as described in the publication "Alabama's Best Management Practices for Forestry" are to be followed at all times. Power and phone boxes in the woods near the ranger office have been flagged and are to be protected from damage during logging operations. No logging traffic will be permitted on Bartram Trail, which runs through the 53 +/- acre select cut area (see map). No trees have been marked to be cut within 50 ft. of the trail. Logger will be allowed to cross the trail at only one location, to be agreed upon between logger and AFC representative. **Also, no logging traffic will be permitted on Forest Service Rd. 949 (see map) except on the first 200 ft. or so beginning at AL Hwy 186.**

**BIDDING**

**Lump-sum bids will be received until 10:00 AM on August 6, 2020 at the AFC state office at 513 Madison Ave. in downtown Montgomery, for purchase of all timber officially designated for sale. Please use the attached bid form. Mailed bids should be clearly addressed to "National Forest Timber Sale #20-10, c/o David Kelley, P.O. Box 302550, Montgomery, AL 36130-2550". The envelope containing the bid should also be marked "Sealed bid to be opened on 8/6/20". Bids will also be accepted by e-mail at: [david.kelley@forestry.alabama.gov](mailto:david.kelley@forestry.alabama.gov). Bids received after 10:00 AM on August 6, 2020 will not be considered. The AFC reserves the right to reject any and all bids. All bidders will be duly notified of the bid results.**

**CONTRACT**

A contract form similar to the one to be executed for this timber sale may be viewed online at [www.forestry.alabama.gov](http://www.forestry.alabama.gov) or obtained by calling David Kelley at the phone number below. The length of the cutting contract will be for 12 months. If necessary, a 3-month extension may be purchased for 10% of the purchase price. The successful bidder will also be required to post a performance bond for the sale area at the time of the contract negotiations in the amount of \$5,000.

**HOW TO SEE TIMBER**

Interested bidders may inspect the sale area at any time. For additional information call David Kelley at 334-850-3069 (cell).

Dated this 14<sup>th</sup> day of July 2020

State of Alabama  
Alabama Forestry Commission  
David M. Kelley, RF #1847  
State Lands Forester

# BID FORM

NATIONAL FORESTS IN ALABAMA  
TUSKEGEE DISTRICT  
TIMBER SALE #20-10

DATE \_\_\_\_\_

NAME OF FIRM \_\_\_\_\_

ADDRESS \_\_\_\_\_

CITY, STATE, ZIP \_\_\_\_\_

TELEPHONE \_\_\_\_\_

**LUMP-SUM BID ON NATIONAL FORESTS IN ALABAMA TIMBER SALE #20-10:**

\$ \_\_\_\_\_

SIGNED \_\_\_\_\_

PRINTED \_\_\_\_\_

\_\_\_\_\_  
OFFICIAL DESIGNATION OF SIGNEE

# Skee TS GNA Project Area

**Legend**

- Road
- First Thinning
- Clearcut w/ Reserves
- Intermediate Thinning

**Trails**

**TRAIL\_NAME**

- BARTRAM
- BOLD DESTINY HORSE TRAIL
- PLEASANT HILL MTN BIKE TRAIL

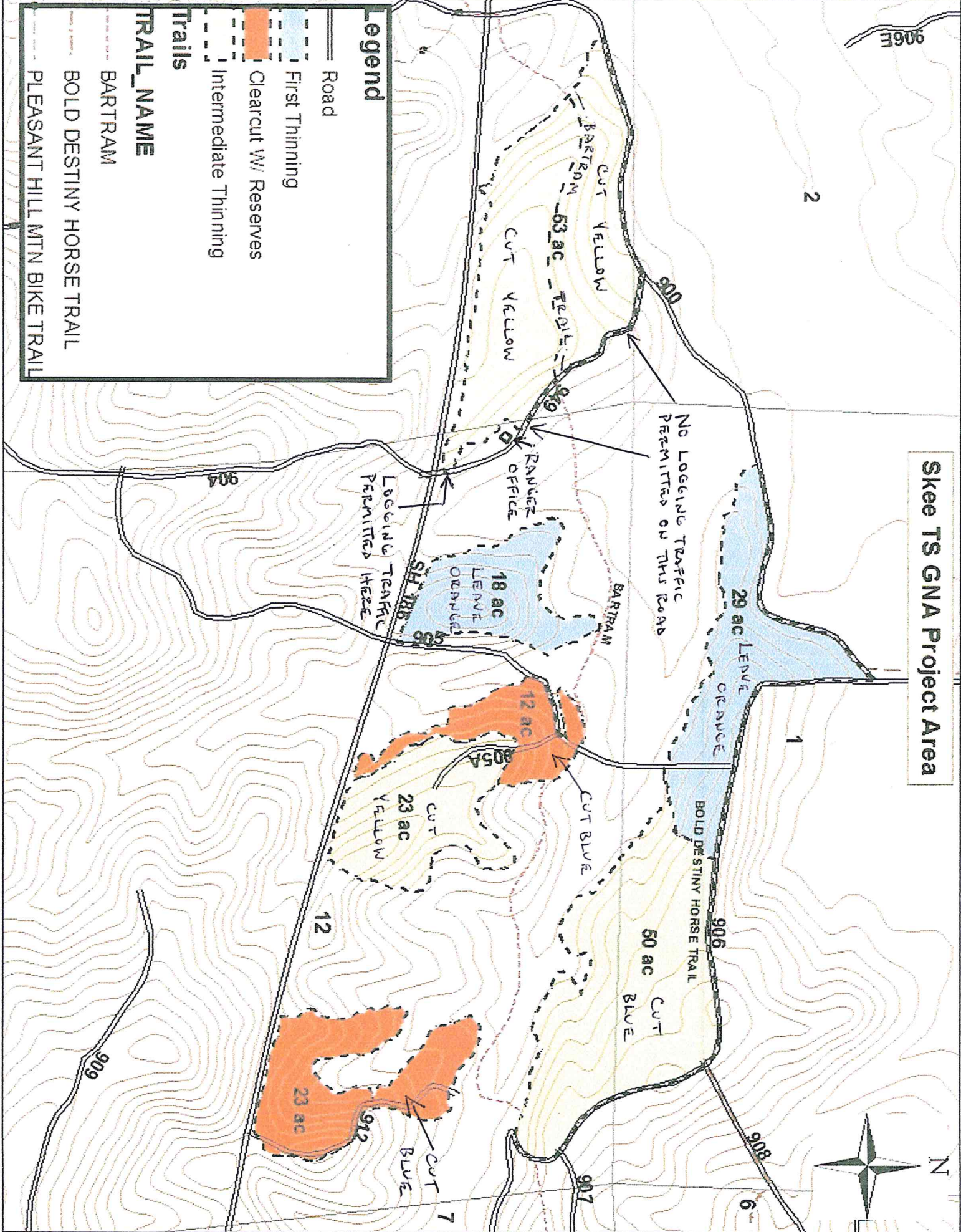

**NATIONAL FORESTS IN ALABAMA  
TIMBER SALE #20-10  
MACON COUNTY, AL**

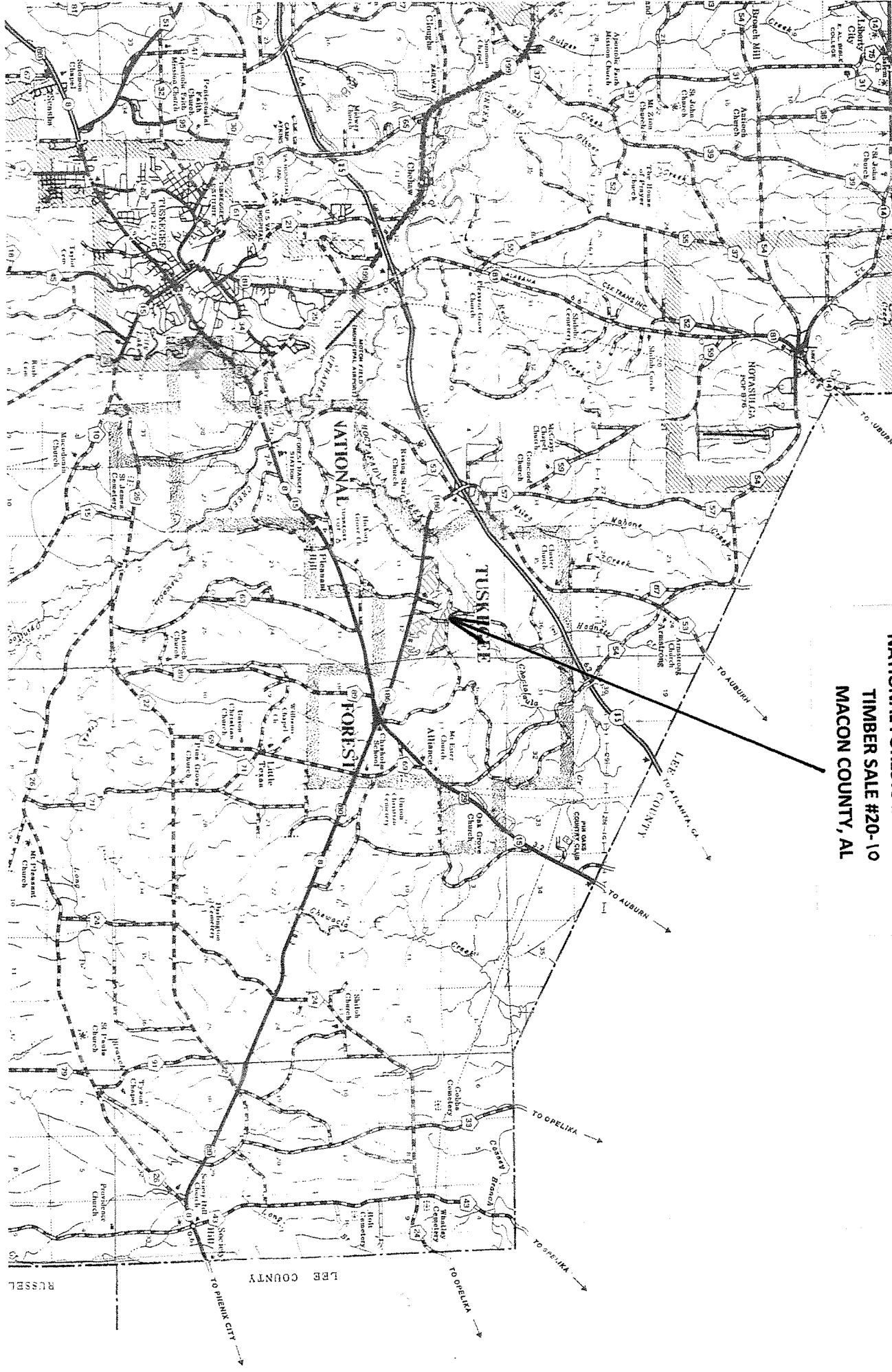

- R INTER
- PRIMIT
- URMAMP
- GRADE
- SOIL S
- GRAVEL
- PAVED
- PAVED
- DIVIDE
- 4 LANE
- SIDE R
- INTERC
  
- ARTER
- U. S. N
- STATE
- COUNT
- NATION
  
- DECK
- FERRY
- LIGHT
- RAILROAD
- RAILROAD
- RAILROAD
- RAILROAD
- RAILROAD
  
- STATE
- COUNT
- COUNT
- OTHER
- INCORP
  
- DAM W
- HIGHW
- CAUSE
- HANDR
- FORN -
- CATL
- GATE /